

CORAL

TOWNHOME / 2 BEDROOMS + DEN / 2 1/2 BATHS • 1430 SQ. FT.

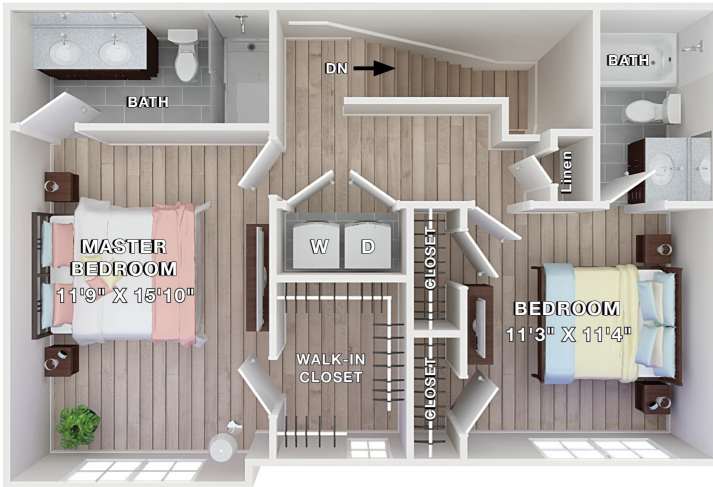

Third Level



Second Level

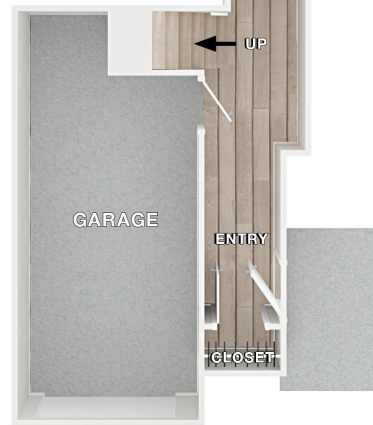

Entry Level



WOODMONTCOVE

100 Celecki Drive, South Amboy, NJ 08879 • Across from the YMCA
WoodmontCove.com

DATE OF QUOTE: _____

PRICE / LEASE TERM: _____

TOWNHOME #: _____

DATE AVAILABLE: _____

This is an artist's rendering. Completed building may vary from plan. All room sizes, dimensions, materials, square footage are approximate and subject to as-built conditions. Some apartments may be the mirror image of this plan. Vanity, toilet, tub, windows, and closets may vary in appearance, size and location based upon the apartment's location within the building. All dimensions are estimates only and may not be exact measurements. Floor plans and development plans are subject to change. The sketches, renderings, graphic materials, plans, specifics, terms, conditions and statements are proposed only, and the developer, the management company, the owners and other affiliates reserve the right to modify, revise or withdraw any or all of same in their sole discretion and without prior notice. All pricing and availability is subject to change. The information is to be used as a point of reference and not a binding agreement

Townhome: C

